



Register your product and get support at
www.philips.com/welcome

PhotoFrame

SFF2307
SFF2327



EN Quick start guide
ZH-CN 快速入门指南

© Royal Philips Electronics N.V. 2010
All rights reserved.

Specifications are subject to change without notice.
Trademarks are the property of Koninklijke Philips
Electronics N.V. or their respective owners.

V1.1 Printed in China

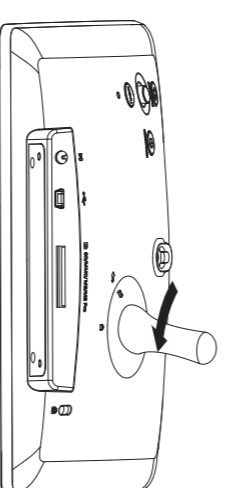
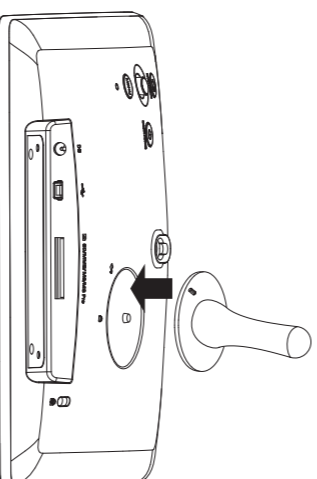
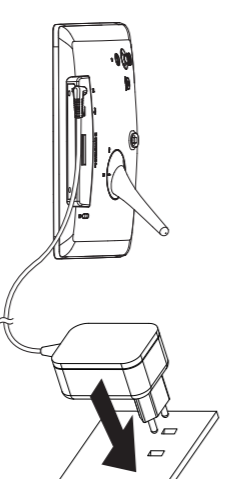
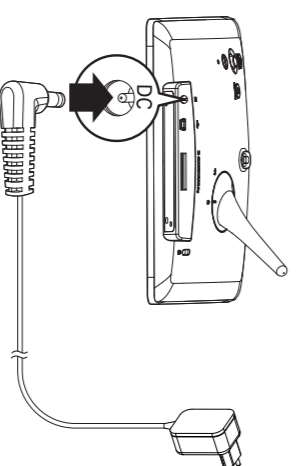
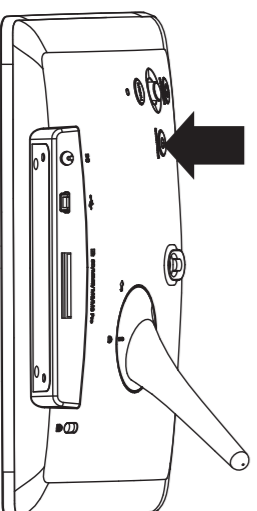
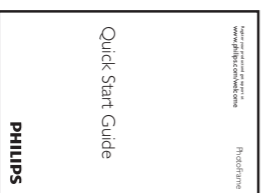
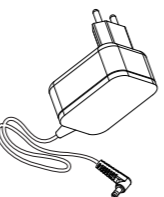
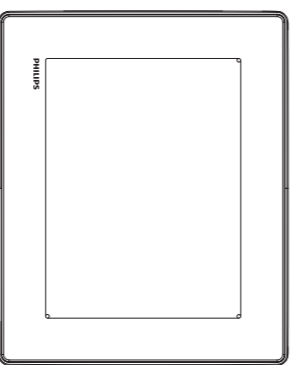

PHILIPS

English

Know these buttons

Control Buttons	Functions
	- Hold to turn on/off the PhotoFrame - Press to switch mode: slideshow/clock/calendar
	- Press to go back step by step - Hold to access the home screen
MENU	- Press to enter/exit a menu
OK (joystick)	- Press to play, pause, or resume slideshow - Press to confirm a selection - Move up/down/right/left to select the upper/lower/right/left option

Know these keypad icons

	Input in English
	Input in supported European languages
	Input in Simplified Chinese
Русский	Input in Russian
\$#* / ABC	Switch to select symbols, punctuations, alphabet or numbers
aA	Switch between upper and lower case
	Enter a blank space
	Enter a line break

Startup

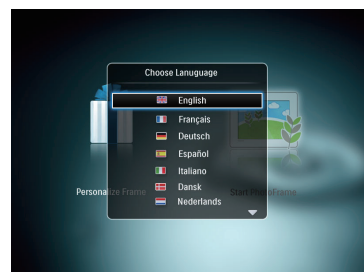

- 1 Connect the power cord to the DC socket of the PhotoFrame and then to a power supply socket.
↳ A few seconds later, the PhotoFrame turns on automatically.
- 2 Move the joystick up/down to select a language, and then press **OK**.
- 3 Move the joystick up/down/right/left to set time and date, and then press **OK**.
- 4 To start PhotoFrame, select **[Start PhotoFrame]** and then press **OK**.
- 5 To start slideshow, select **[Play]** and then press **OK**.

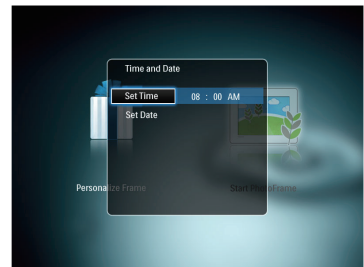

- To pause slideshow, press **OK**.
- To resume slideshow, press **OK** again.
- To turn off the PhotoFrame, hold **⏻**.



Transfer photos with a storage device

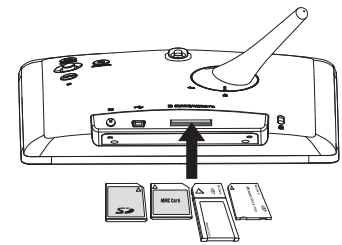

- Media type supported:**
- Photo (JPEG)
- Storage device supported:**
- Secure Digital (SD)
 - Secure Digital High Capacity (SDHC)
 - Multimedia Card (MMC)
 - Memory Stick (MS)
 - Memory Stick Pro (MS Pro)

- 1 Insert a storage device into the PhotoFrame.
↳ An option menu is displayed.
- 2 Select an option, and then press **OK**.
- 3 Follow the on screen instructions to:
 - Play photos on the storage device
 - Browse photos on the storage device
 - Copy photos on the storage device to PhotoFrame

View a message

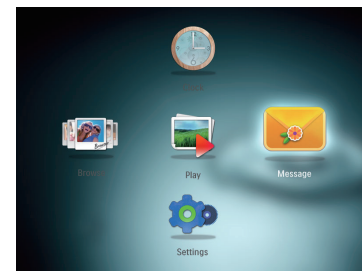

View a pop-up message:
If you have a pop-up message, the PhotoFrame prompts that you have a gift. Then, press **OK** to view the message.

- View a message via the home screen:**
- 1 In the home screen, select **[Message]** and then press **OK**.
 - 2 Select **[View Message]**, and then press **OK**.
 - 3 Move the joystick right/left to select a message, and then press **OK** to view the message.

简体中文

认识这些按钮

控制按钮	功能
	- 按住打开/关闭相框 - 按下切换模式: 幻灯片/时钟/日历
	- 按下逐步返回 - 按住进入主屏幕
MENU	- 按下进入/退出菜单
OK (操纵杆)	- 按下播放、暂停或恢复幻灯片放映 - 按下确认选择 - 向上/向下/向右/向左移动选择上面/下面/右边/左边的选项

认识这些键盘图标

	输入英语
	输入支持的欧洲语言
	输入简体中文
Русский	输入俄语
\$#* / ABC	切换选择符号、标点符号、字母或数字
aA	在大写字母和小写字母之间切换
	输入空格
	输入换行符

通过存储设备传输照片

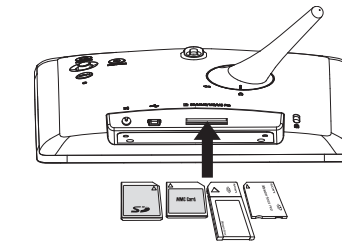

- 支持的媒体类型:**
- 照片 (JPEG)
- 支持的存储设备:**
- SD 存储卡
 - Secure Digital High Capacity (SDHC) 卡
 - MMC 卡
 - Memory Stick (MS)
 - Memory Stick Pro (MS Pro)

- 1 将存储设备插入数码相框。
↳ 将显示选项菜单。
- 2 选择一个选项, 然后按 **OK**。
- 3 按照屏幕上的说明执行以下操作:
 - 在存储设备上播放照片
 - 在存储设备上浏览照片
 - 将存储设备上的照片复制到相框

查看留言

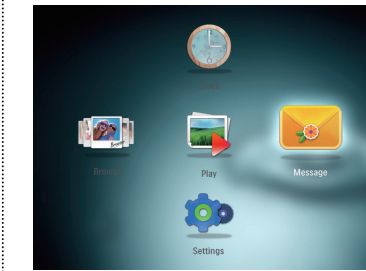

查看弹出留言:
如果收到弹出留言, 这是数码相框提醒您收到了礼物。此时按 **OK** 可查看留言。

- 通过主屏幕查看留言:**
- 1 在主屏幕中, 选择 **[信息]**, 然后按 **OK**。
 - 2 选择**[查看信息]**, 然后按 **OK**。
 - 3 向右/向左移动操纵杆选择留言, 然后按 **OK** 查看留言。

Startup



- 1 Connect the power cord to the DC socket of the PhotoFrame and then to a power supply socket.
↳ A few seconds later, the PhotoFrame turns on automatically.
- 2 Move the joystick up/down to select a language, and then press **OK**.
- 3 Move the joystick up/down/right/left to set time and date, and then press **OK**.
- 4 To start PhotoFrame, select **[Start PhotoFrame]** and then press **OK**.
- 5 To start slideshow, select **[Play]** and then press **OK**.

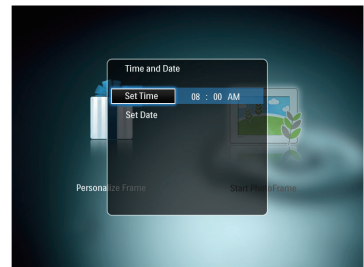

- To pause slideshow, press **OK**.
- To resume slideshow, press **OK** again.
- To turn off the PhotoFrame, hold **⏻**.



Create a message

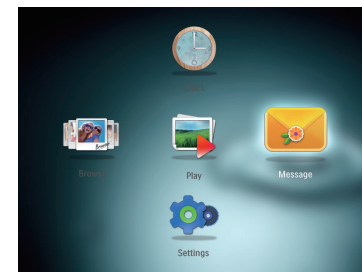

Tip

- If there is no message created before, at power up select **[Personalize Frame]** to add a message to your photo or to view a message.

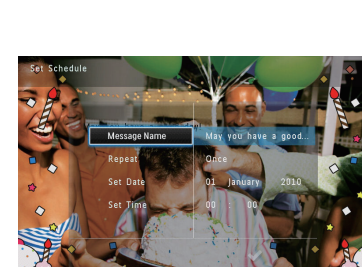
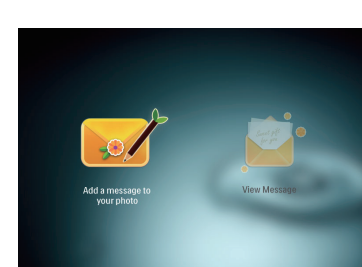

- 1 In the home screen, select **[Message]** and then press **OK**.
- 2 Select **[Add Message to your photo]**, and then press **OK**.
- 3 Move the joystick right or left to select a message template, and then press **OK**.
- Edit the text of the message or change photo of the message.
- Set the real time and date if applicable.
- 4 Select **[Done]**.
↳ The screen prompts you to schedule the message.
- 5 Schedule the message.
 - **[Message name]:** Enter the name
 - **[Repeat]:** Select a repeat frequency
 - **[Set Date]:** Set the date or day
 - **[Set Time]:** Set the time
- 6 After you complete the message, select **[Done]** and press **OK**.

- To view the available messages, select **[View Message]**.
- To go back to the home screen, hold **⏻**.

启动

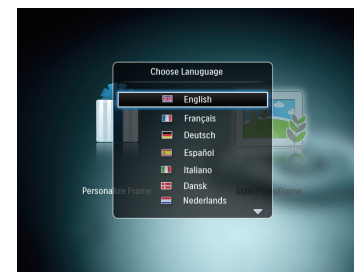

- 1 将电源线连接到相框的 DC 插孔, 然后再连接到电源插座。
↳ 几秒钟后, 数码相框会自动打开。
- 2 向上/向下移动操纵杆选择语言, 然后按 **OK**。
- 3 向上/向下/向右/向左移动操纵杆设置时间和数据, 然后按 **OK**。
- 4 要启动数码相框, 请选择 **[启动相框]**, 然后按 **OK**。
- 5 要开始幻灯片放映, 请选择 **[播放]**, 然后按 **OK**。

- 要暂停幻灯片放映, 请按 **OK**。
- 要继续幻灯片放映, 请再次按 **OK**。
- 要关闭数码相框, 请按住 **⏻**。

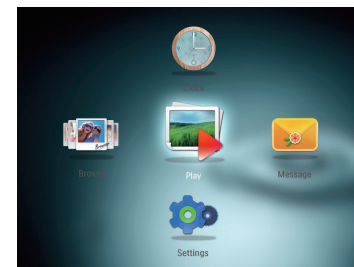
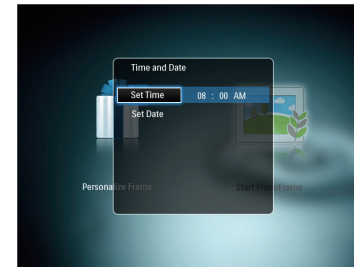

创建留言

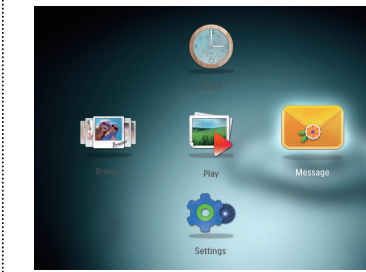

提示

- 如果以前没有创建过留言, 请在启动时选择 **[个性化相框]** 添加留言到您的照片或查看留言。

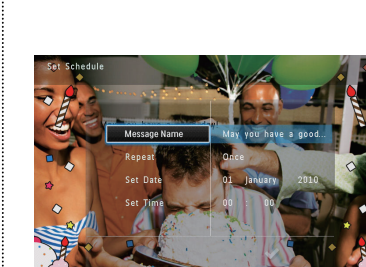
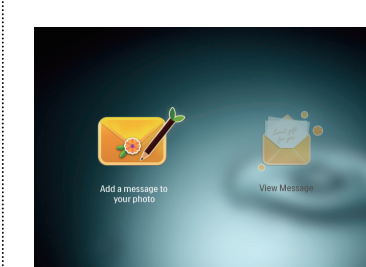

- 1 在主屏幕中, 选择 **[信息]**, 然后按 **OK**。
- 2 选择**[为您的照片添加消息]**, 然后按 **OK**。
- 3 向右或向左移动操纵杆选择留言模板 **OK**, 然后按“确定”。
- 编辑留言的文字或更改留言的照片。
- 如果适用, 设置确切的时间和日期。
- 4 选择 **[完成]**。
↳ 屏幕将提示您排定留言。
- 5 排定留言。
 - **[信息名称]:** 输入名称。有关情况, 请参阅“输入留言的名称”。
 - **[重复播放]:** 选择重复播放频率。
 - **[设置日期]:** 设置日期或星期几
 - **[设置时间]:** 设置时间
- 6 完成留言之后, 请选择 **[完成]**, 然后按 **OK**。

- 要查看可用留言, 请选择 **[查看信息]**。
- 要返回主屏幕, 请按住 **⏻**。